

PEARL

C5061

All-round harness specially designed to fit female body.

CE 1019

EN 12277



3 years guarantee
3 roky záruka



Reading and understanding instruction for use are required to use this product!
Bez důkladného prečtení a pochopení návodu k použití nepoužívejte tento výrobek

Material
Materiál polyamid
polyester

Weight
Váha 390 g
13,76 oz

Size
Velikosti XS, S, M,
L, XL

Temperatur
Rozsah teplot -40 °C
+80 °C

Description:

This ergonomic construction combines maximum comfort and low weight.

Specially shaped waist belt and longer belay loop to fit women's physique.

The new ergonomic braided gear loops are shaped to facilitate handling and to provide enough space for your climbing gear.

Three Rock&Lock buckle.

Unique, patented Rock&Lock buckle are newly made of stainless steel to increase corrosion resistance.

Graceful design for women's climbing

New webbing is more durable and works better in our R&L buckle, making the tightening smoother.

For both leg loops and waist belt the variable width webbing is used.

Bright color longer belay loop 12 mm with strength 15 kN.

Thanks to the Rock&Lock buckles on the leg loops it is possible to put the harness on without having to take your skis or crampons off.

Fixed bridge between the leg loops provides a greater safety in case of incorrect tying.

Technical data:

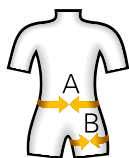

| | SIZE | K1 | K2 | XS | S | M | L | XL | XXL |
|-------------------|--------|----|----|-----------|-----------|-----------|-----------|-----------|-----|
| Pearl m(g) 390 | A [cm] | | | 60-70 | 65-75 | 70-80 | 75-85 | 80-90 | |
| | A [in] | | | 21,5-25,5 | 25,5-29,5 | 27,5-31,5 | 29,5-33,5 | 31,5-35,5 | |
| | B [cm] | | | 45-50 | 50-55 | 55-60 | 60-65 | 65-70 | |
| | B [in] | | | 17,5-19,5 | 19,5-21,5 | 21,5-23,5 | 23,5-25,5 | 21,5-23,5 | |

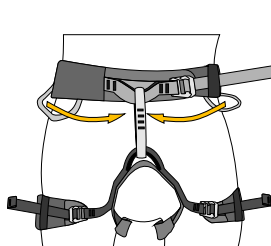

Waist belt tightening.

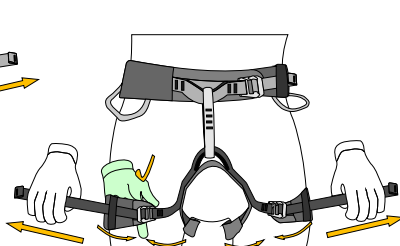

Legs loops tightening .
Keep space for hand.

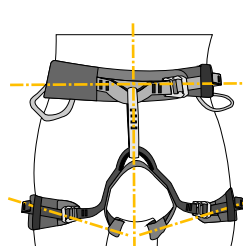

Correctly adjusted harness

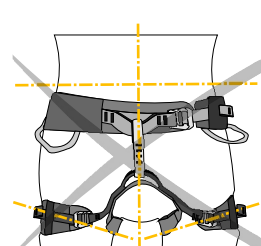

Waist belt is too low.
Legs are too tight.

SINGING ROCK

Let's rock!



Power distribution at the waist:

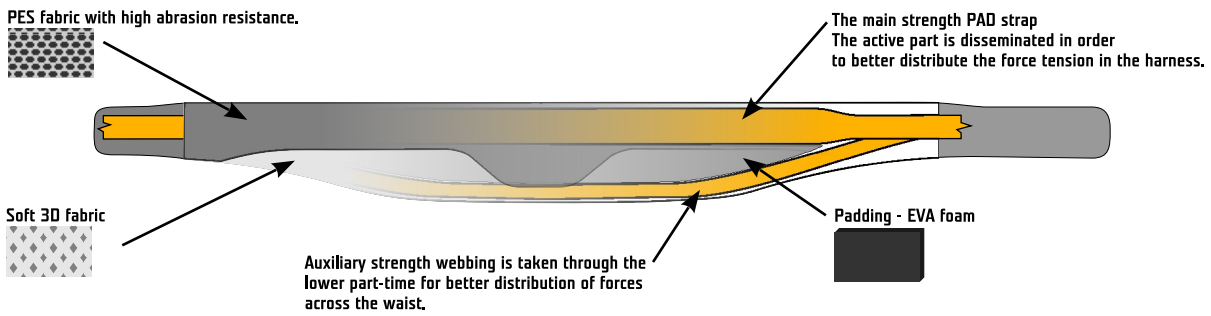

Harness systems:

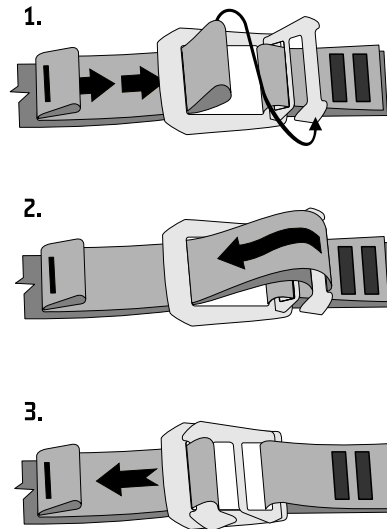
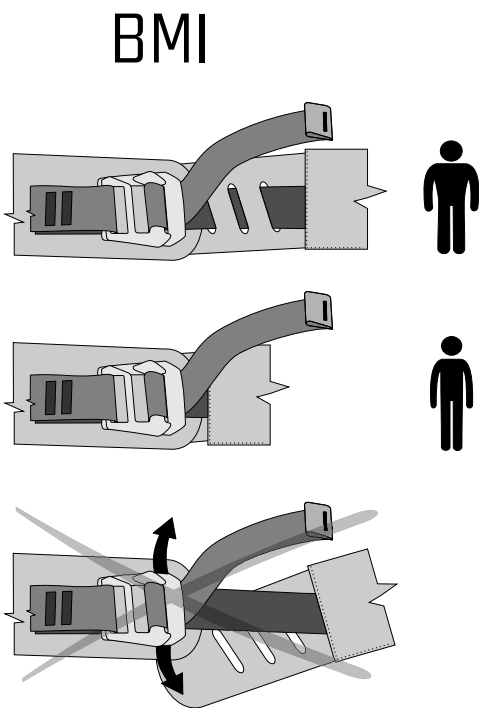

Tying in on the belay loop:

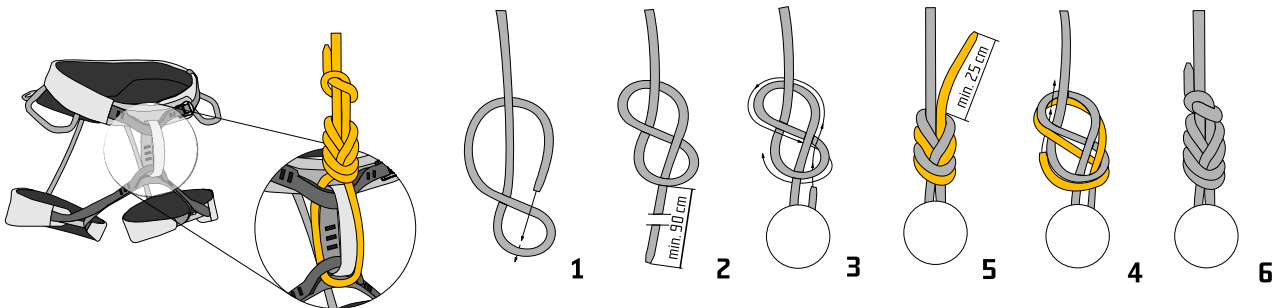

Maintenance:

